

**CSOP3050PM/S/P****FEATURES**

The elegant, modern aesthetics pair perfectly with a full suite of similarly styled Sub-Zero, Wolf, and Cove appliances

Full-color touchscreen simplifies use

The door opens and closes quietly for an elevated experience

Save up to 50 personalized recipe presets for quick access to your favorite go-to meals

Cooking modes include Steam, Convection, Broil, Slow Roast

Oven features a 1750-watt recessed broil element with multiple settings

2.4 cubic-foot oven cavity allows multiple dishes to be placed side by side at once

1889-watt dual convection system ensures even, multi-rack baking and consistent results

Three full-extension rack positions and one standard position allow easy access and increased cooking flexibility

Plumbed water supply provides continuous steam cooking

The temperature probe alerts you when your dish has reached the desired temperature

**ACCESSORIES**

Broiler Rack

Descaling Solution

Enameled Broiler Pan

Perforated Pan - 12 3/4" x 1 1/2" x 7"

Perforated Pan - 24 3/4" x 1 3/8" x 14 1/2"

Solid Pan - 12 3/4" x 1 1/2" x 7"

Solid Pan - 24 3/4" x 1 3/8" x 14 1/2"

Standard Oven Rack

Temperature Probe

Accessories available through an authorized dealer.

For local dealer information, visit [subzero-wolf.com/locator](http://subzero-wolf.com/locator).



**PRODUCT SPECIFICATIONS**

|                          |  |
|--------------------------|--|
| Model                    | CSOP3050PM/S/P   |
| Dimensions               | 29 7/8"W x 17 7/8"H x 22 1/2"D                                 |
| Oven Interior Dimensions | 25 1/4"W x 10 3/4"H x 15 1/8"D                                 |
| Overall Capacity         | 2.4 cu. ft.  |
| Usable Capacity          | 1.8 cu. ft.  |
| Door Clearance           | 14 3/16"   |
| Weight                   | 91 lbs   |
| Electrical Supply        | 240/208 VAC, 60 Hz   |
| Electrical Service       | 20 amp dedicated circuit                                       |
| Drain Line TestSpec      | 10' (3 m) corrugated drain tubing                              |
| Plumbing Supply          | 6.5' (2 m) braided tubing with 3/8" female compression fitting |
| Plumbing Pressure        | 15–145 psi   |
| Conduit Length           | 4 Feet   |

**DIMENSIONS**

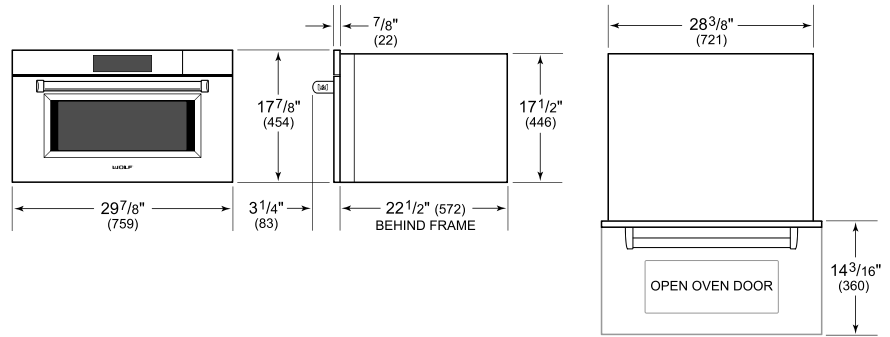

**ELECTRICAL**

**PLUMBING**

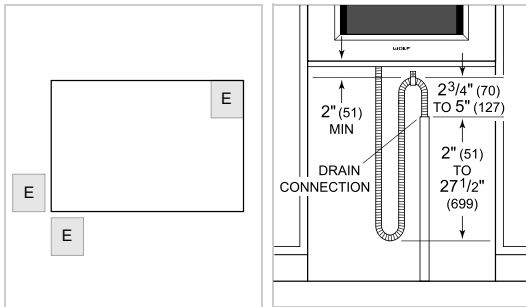

NOTE: Dimensions in parenthesis are in millimeters unless otherwise specified

**STANDARD INSTALLATION**

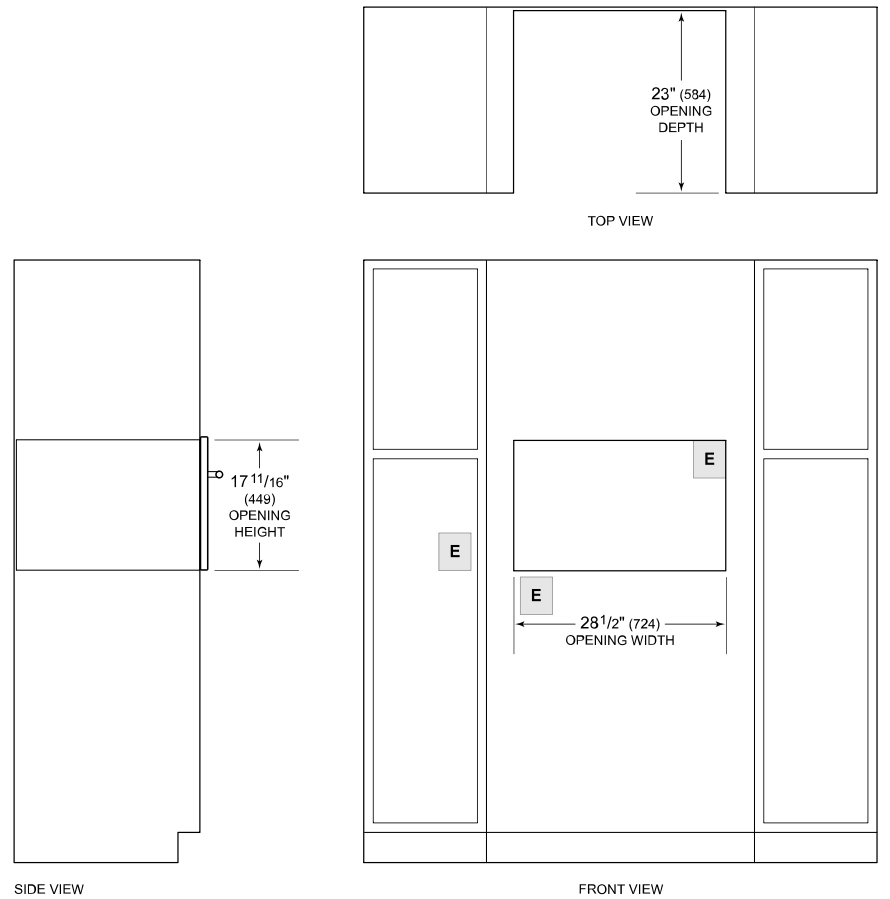

NOTE: Location of electrical supply within opening may require additional cabinet depth.